



PROJECT *Update*

Issue #2 July 2016

ZONE 41 GROUNDWATER WELL DOWNHOLE CONSTRUCTION: ARDEN WAY WELL (W23)

Purpose of this Newsletter

This newsletter provides current information about the Zone 41 Groundwater Well Downhole Construction: Arden Way Well Project.

Background

Sacramento County Water Agency (SCWA) has identified the need to increase capacity and reliability within the distribution system located in the Arden Park service area by adding an additional water source.

SCWA will drill one municipal well at 3824 Arden Way, Sacramento, CA 95864 (see map on the back of the newsletter). The drilling activities will require 24-hour operations during critical portions of the project (including three to five days of continuous drilling). The 24-hour-a-day operation keeps the bore hole open while it is drilled and shortens the construction period. The work area must be illuminated during the 24-hour drilling period to ensure the safety of workers. In addition, the drill rig will produce a droning sound that will be audible outside the work area. Sound walls will be placed in order to mitigate noise from the drilling equipment. SCWA will make every effort to shorten the length of time required for the drilling operation.

The drilling contractor is committed to minimizing impacts from light and noise throughout the work conducted at the site, but disturbances should be expected.

Project updates

The construction contract was awarded to Zim Industries on May 24, 2016. The contractor will be mobilizing on-site and setting up sound walls beginning early August. Drilling of the borehole will follow.

Larry Ernst of Wood Rogers will be working with SCWA to provide project oversight. Please contact Helen Rocha during business hours, to answer any of your questions or to address concerns about the project. In case of an emergency or concerns during after-hours, please use the after-hours hotline.

Scope of Work

The project will include drilling the municipal well and well purging, thus discharging excess water into the storm drain. Unfortunately, there is no practical method to capture or re-use the purged water. The well drilling and construction phase will take approximately 1 week. The well purging phase will take some time and requires discharging to the storm drain system along Arden Way. The water quality of the purged water will be frequently tested to determine when the well purging can stop.

We thank you for your cooperation and understanding while SCWA conducts this important drinking water supply project.

Working Hours

Prior to, and following 24-hour operations, work will be conducted during daylight hours between 7:00 a.m. and 8:00 p.m. on weekdays, and 7:00 a.m. and 8:00 p.m. on weekends

Project Schedule

Begin Construction: August 3, 2016 – **NEW**
End Construction: October 2016 - (tentative)

Contact Information

Helen Rocha
Project Engineer, business hours: (916) 876-7191
E-mail: rochah@saccounty.net

Larry Ernst
On-site Project Manager, business hours: (916) 341-7447

After Hours Hotline: Larry Ernst (916) 417-7687

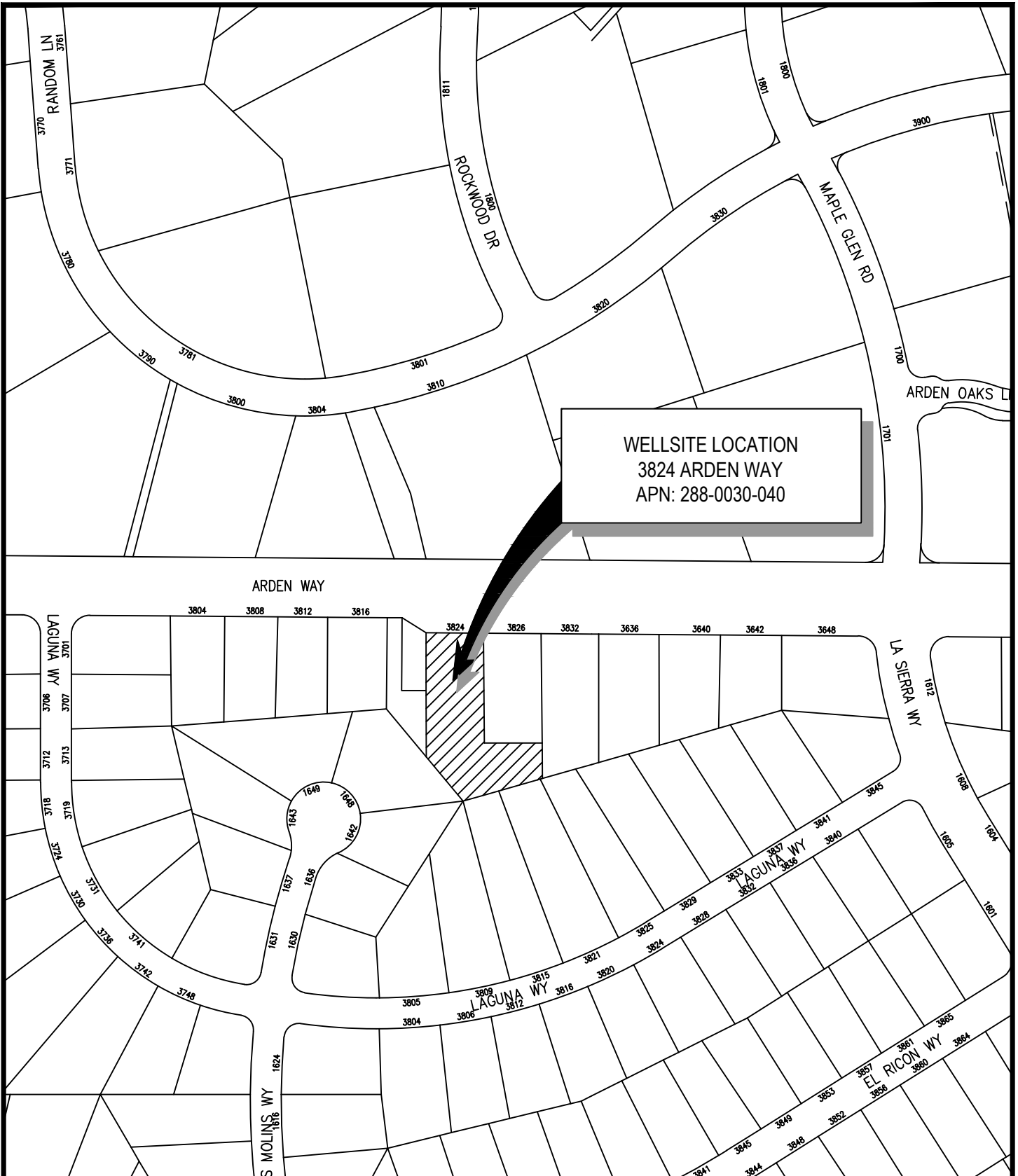

WELLSITE LOCATION
 3824 ARDEN WAY
 APN: 288-0030-040



SACRAMENTO COUNTY WATER AGENCY

Department of Water Resources

EXHIBIT/GRAPHIC TITLE:
 ARDEN WAY WELL SITE
 LOCATION MAP

PROJECT: ARDEN WAY WELL SITE
 PROJECT ENGINEER: H. ROCHA

SCALE: NTS DATE: 02/19/16 DRAWN BY: Y. OUSHAKOFF