



PROJECT *Update*

Issue #1 February 2016

ZONE 41 GROUNDWATER WELL DOWNHOLE CONSTRUCTION: ARDEN WAY WELL (W23)

Purpose of this Newsletter

A groundwater well is scheduled to be constructed in your neighborhood. Your home is within 500-feet of the construction site. The Sacramento County Water Agency (SCWA) will keep you informed of the project scope, schedule and deadlines through project newsletters.

No action is required on your part.

Background

SCWA has identified the need to increase capacity and reliability within the distribution system located in the Arden Park service area by adding an additional water source.

SCWA will drill one municipal well at 3824 Arden Way (APN 288-0030-040). During the summer of 2014, SCWA drilled a monitoring well to confirm that this site was suitable for a municipal water well. In February, SCWA demolished the existing on-site structures in order to accommodate the new facility.

Construction of the new well is scheduled to begin in May. The drilling activities will require 24-hour operations during critical portions of the project (including three to five days of continuous drilling). The 24-hour-a-day operation keeps the hole open while it is drilled and shortens the construction period. The work area must be illuminated during the 24-hour drilling period to ensure the safety of workers. In addition, the drill rig will produce a droning sound that will be audible outside the work area. Sound walls will be placed in order to mitigate noise from the drilling. SCWA will make every effort to shorten the length of time required for the drilling operation.

The drilling contractor is committed to minimizing impacts from light and noise throughout the work conducted at the site, but disturbances should be expected.

Larry Ernst of Wood Rogers will be working with SCWA to provide project oversight and serve as the project manager. Mr. Ernst will be available for the duration of this project to answer your questions or to address any concerns. His contact information can be found in the blue box.

Scope of Work

The project will include drilling the municipal well and well purging, thus discharging excess water into the storm drain. Unfortunately, there is no practical method to capture or re-use the purged water. The well drilling and construction phase will take approximately 1 week. The well purging phase will take some time and requires discharging to the storm drain system along Arden Way. The water quality of the purged water will be frequently tested to determine when the well purging can stop.

We thank you for your cooperation and understanding while SCWA conducts this important drinking water supply project.

Working Hours

Prior to, and following 24-hour operations, work will be conducted during daylight hours between 6:00 a.m. and 8:00 p.m. on weekdays, and 7:00 a.m. and 8:00 p.m. on weekends

Project Schedule

Begin Construction: May 23, 2016 - (tentative)

End Construction: August 1, 2016 - (tentative)

Contact Information

Helen Rocha, Associate Engineer, (916) 876-7191

E-mail: rochah@sacounty.net

Kathleen Grant, Assistant Engineer, (916) 875-5808

E-mail: grantk@sacounty.net

Larry Ernst, Project Manager, business hours
(916) 341-7447

After Hours Hotline: Larry Ernst (916) 417-7687

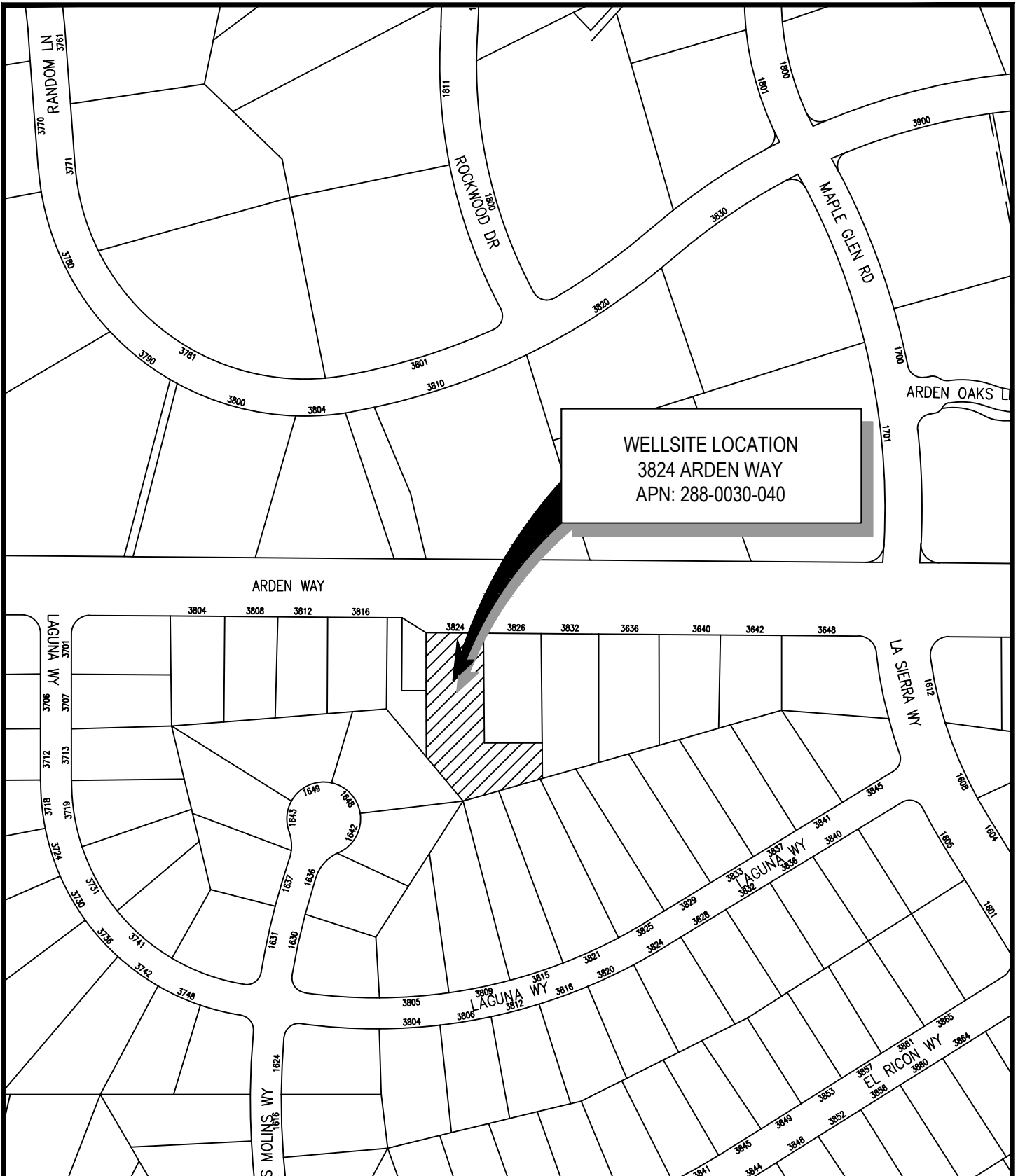

WELLSITE LOCATION
 3824 ARDEN WAY
 APN: 288-0030-040

SACRAMENTO COUNTY WATER AGENCY



EXHIBIT/GRAPHIC TITLE:

ARDEN WAY WELL SITE
 LOCATION MAP

PROJECT: ARDEN WAY WELL SITE

PROJECT ENGINEER: H. ROCHA

SCALE: NTS

DATE: 02/19/16

DRAWN BY: Y. OUSHAKOFF